

ANSON COURT

GUNWHARF QUAYS | PORTSMOUTH | PO1 3BG



£285,000
Leasehold

- Stunning One Bed Penthouse Apartment
- Highly Requested Gunwharf Quays Development
- Open Plan Living/Dining/Kitchen with Balcony
- Amazing Views Over The Canal and Harbour
- Full Width Balcony across the Length of The Apartment
- Double Bedroom With Adjoining Bathroom
- Secure Underground Car Parking Bay
- No Forward Chain : Viewing Highly Recommended





In Brief

Fry & Kent has the pleasure of marketing for sale this fabulous one bedroom PENTHOUSE apartment situated in the highly requested Gunwharf Quays development. This COSMOPOLITAN marina complex offers a desirable choice of cafes, bars and restaurants as well as a multi screen cinema and casino. These alongside a wide variety of designer shops are right on your doorstep.

On entering this well maintained, MODERN apartment block you have the choice of taking the stairs or the lift up to the penthouse floor. On walking through the entrance, the hallway leads you through to the bedroom with floor to ceiling sliding french doors leading out to the balcony overlooking the PICTURESQUE canalside and marina. The adjoining bathroom is spacious and CONTEMPORARY. The apartment boasts an OPEN PLAN kitchen, living, dining room which once again leads out to the balcony - the perfect setting for relaxing or entertaining.

Benefitting from a long lease, secure underground allocated parking and no forward chain, viewings are recommended at your earlier convenience to avoid disappointment.

£285,000

KEY FACTS

TENURE: Leasehold

TERM: 199 years from 1999

GROUND RENT: £150 pa

CHARGE: £1500 pa

EPC RATING: 'C'

COUNCIL TAX BAND: 'C'



ANSON COURT

GUNWHARF QUAYS | PORTSMOUTH | PO1 3BG



Anson Court, Gunwharf Quays, Portsmouth

Approximate Gross Internal Area = 54.8 sq m / 590 sq ft

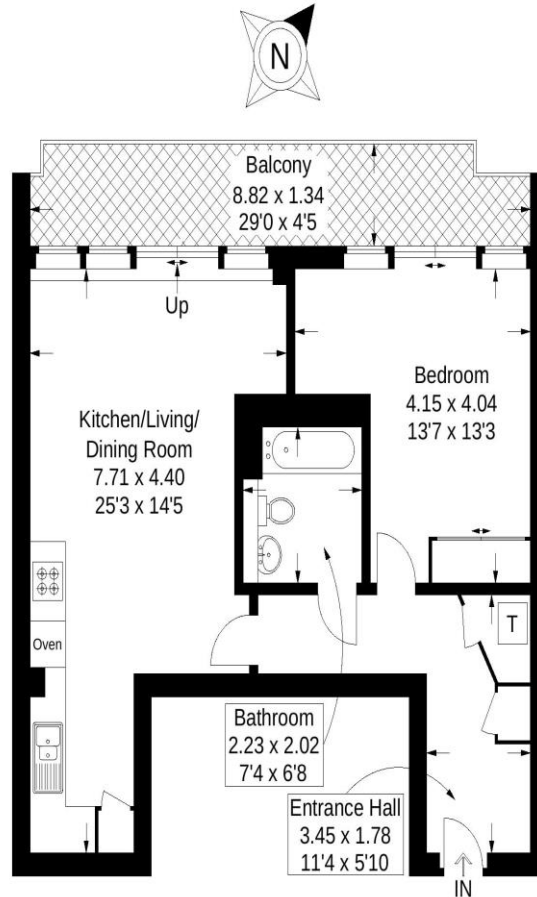

Fifth Floor

This plan is for layout guidance only. Not drawn to scale unless stated. Windows and door openings are approximate. Whilst every care is taken in the preparation of this plan, please check all dimensions, shapes and compass bearings before making any decisions reliant upon them.

Southsea
Sales & Lettings
7/9 Stanley Street,
Southsea, PO5 2DS
Tel: 023 9281 5221

Old Portsmouth & Gunwharf Quays
Sales & Lettings
The Seagull, 13 Broad Street,
Old Portsmouth, PO1 2JD
Tel: 023 9281 5221

Drayton & Out of Town
Sales & Lettings
139 Havant Road,
Drayton, PO6 2AA
Tel: 023 9221 0101

London
Sales & Lettings
Mayfair Office, Cashel House,
15 Thayer Street, W1U 3JT
Tel: 0870 112 7099

Southsea
Admin Centre
12 Marmion Road,
Southsea, PO5 2BA
Tel: 023 9282 2300

www.fryandkent.com